

UPort® 1100 Series

1-port RS-232, RS-422/485, and RS-232/422/485 USB-to-serial converters



Terminal Block Adapter for the UPort® 1130/1130I/1150/1150I

- > Compatible with USB 2.0
- > 12 Mbps USB data rate
- > 921.6 kbps maximum baudrate for super fast data transmission
- > Drivers provided for Windows, WinCE, and Linux
- > Mini DB9 female to terminal block adapter for easy wiring
- > LEDs for indicating USB and TxD/RxD activity
- > 2 kV electrical isolation (UPort 1130I and 1150I)



Overview

The UPort® 1100 series USB-to-serial converters are the perfect accessory for laptop computers that do not have a serial port, and they are essential for engineers who need to connect different serial devices in the field or separate interface converters for devices without a standard COM port or DB9 connector. The UPort® 1110 converts from

USB to RS-232, the UPort® 1130/1130I from USB to RS-422/485, and the UPort® 1150/1150I from USB to RS-232/422/485. All products are compatible with new and legacy serial devices, and can be used with mobile, instrumentation, and point-of-sale applications.

Typical Application—Surveillance Monitoring System

The most basic video surveillance setup consists of a single camera connected directly to a monitor and recording device. However, many businesses require video surveillance on a larger scale requiring a dedicated management system. Existing management systems often lack device-port versatility, making converters a necessity when connecting different devices. Management systems that need USB-to-serial converters for serial devices such as card readers, modems, video cameras, and sensors, now have a simple solution. Moxa's UPort® 1100 converters provide plug-and-play serial device connectivity without having to install new adapter boards, which usually requires opening of computer/server chassis. Also, a unique

driver allows the UPort® 1100 to retain COM port numbers when they have been unplugged and then reconnected again, even into a new USB port.

UPort® 1100 convenient characteristics include:

- USB 2.0 compatibility
- RS-232 or RS-422/485 interface
- Stability and reliability
- Cost-effective
- Plug-and-play
- Easy to use

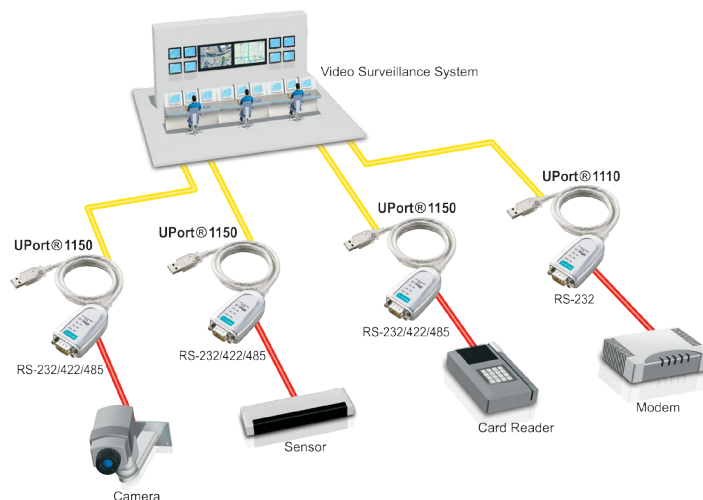

: Specifications

USB Interface

Compliance: USB 1.0/1.1 compliant, USB 2.0 compatible

Connector:

UPort 1110/1130/1130I/1150: USB Type A

UPort 1150I: USB Type B

Speed: 12 Mbps (Full-Speed USB)

Serial Interface

Number of Ports: 1

Serial Standards:

UPort 1110: RS-232

UPort 1130/1130I: RS-422/485

UPort 1150/1150I: RS-232/422/485

Connector: DB9 male

Electrical Isolation: 2 kV (UPort 1130I and 1150I)

Performance

Baudrate: 50 bps to 921.6 kbps

Serial Communication Parameters

Data Bits: 5, 6, 7, 8

Stop Bits: 1, 1.5, 2

Parity: None, Even, Odd, Space, Mark

Flow Control: RTS/CTS, XON/XOFF

FIFO: 64 bytes

Serial Signals

RS-232: TxD, RxD, RTS, CTS, DTR, DSR, DCD, GND

RS-422: TxD+(B), TxD-(A), RxD+(B), RxD-(A), GND

RS-485-4w: TxD+(B), TxD-(A), RxD+(B), RxD-(A), GND

RS-485-2w: Data+(B), Data-(A), GND

RS-485 Data Direction: ADDC® (Automatic Data Direction Control)

Operating Systems

Windows Real COM Drivers: Windows 95/98/ME/NT/2000, Windows XP/2003/Vista/2008/7/8/8.1/10 (x86/x64), Windows 2012 (x64), Windows Embedded CE 5.0/6.0

Linux Real TTY Drivers: Linux 2.4.x, 2.6.x, 3.x

Note: Please refer to Moxa's website for the latest driver support information.

Physical Characteristics

Housing:

UPort 1110/1130/1130I/1150: ABS + PC

UPort 1150I: Metal

Weight:

UPort 1110/1130/1130I/1150:

Product only: 65 g (0.14 lb)

Packaged: 200 g (0.44 lb)

UPort 1150I:

Product only: 75 g (0.65 lb)

Packaged: 320 g (0.72 lb)

Dimensions:

UPort 1110/1130/1130I/1150:

37.5 x 20.5 x 60 mm (1.48 x 0.81 x 2.36 in)

UPort 1150I:

52 x 80 x 22 mm (2.05 x 3.15 x 0.87 in)

Environmental Limits

Operating Temperature: 0 to 55°C (32 to 131°F)

Storage Temperature: -20 to 70°C (-4 to 158°F)

Ambient Relative Humidity: 5 to 95% (non-condensing)

Standards and Certifications

EMC: EN 55022/24

EMI: CISPR 22, FCC Part 15B Class B

ESD:

IEC 61000-4-2 ESD: Contact: 4 kV; Air: 8 kV

IEC 61000-4-3 RS: 80 MHz to 1 GHz: 3 V/m

IEC 61000-4-4 EFT: Power: 1 kV; Signal: 0.5 kV

IEC 61000-4-5 Surge: Power: 2 kV

IEC 61000-4-6 CS: 150 kHz to 80 MHz: 3 V/m

IEC 61000-4-8 PFMF

Power Requirements

Input Voltage: 5 VDC

Input Current:

UPort 1110: 30 mA @ 5 VDC

UPort 1130: 60 mA @ 5 VDC

UPort 1130I: 65 mA @ 5 VDC

UPort 1150: 77 mA @ 5 VDC

UPort 1150I: 260 mA @ 5 VDC

MTBF (mean time between failures)

Time: 1,949,025 hrs

Standard: Telcordia (Bellcore), GB

Warranty

Warranty Period: 5 years

Details: See www.moxa.com/warranty

Cable-Type Dimensions

Unit: mm (inch)

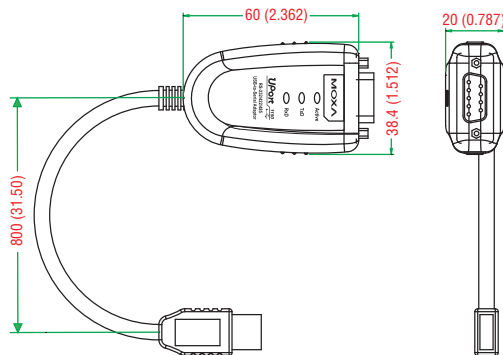

Dimensions

Unit: mm (inch)

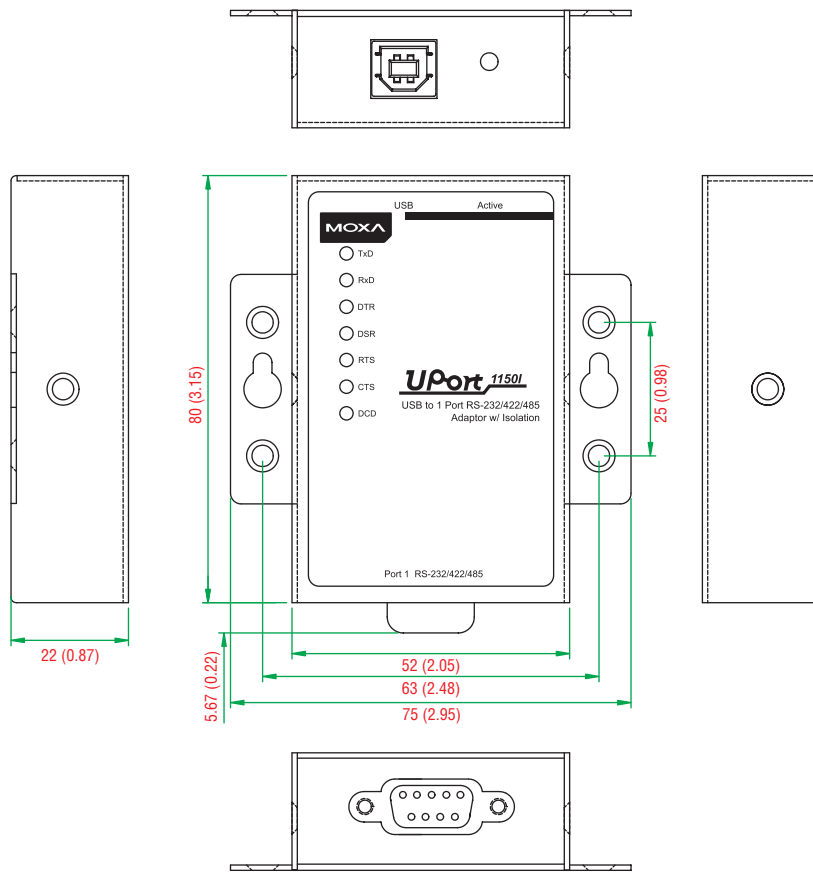

Ordering Information

Available Models

- UPort 1110:** 1-port RS-232 USB-to-serial converter
- UPort 1130:** 1-port RS-422/485 USB-to-serial converter
- UPort 1130I:** 1-port RS-422/485 USB-to-serial converter with 2 kV electrical isolation
- UPort 1150:** 1-port RS-232/422/485 USB-to-serial converter
- UPort 1150I:** 1-port RS-232/422/485 USB-to-serial converter with 2 kV electrical isolation

Optional Accessories (can be purchased separately)

- Mini DB9F-to-TB:** DB9 female to terminal block connector
- CBL-USBA/B-100:** USB Type A to USB Type B cable, 100 cm
- CBL-F9M9-150:** DB9 female to DB9 male serial cable, 150 cm
- CBL-F9M9-20:** DB9 female to DB9 males serial cable, 20 cm
- CBL-RJ45SF9-150:** RJ45 to DB9 female shielded serial cable, 150 cm
- ADP-RJ458P-DB9:** DB9 female to RJ45 connector
- A-ADP-RJ458P-DB9F-ABC01:** DB9 female to RJ45 connector

Cable-Type Package Checklist

- 1 UPort 1110 or 1130 or 1130I or 1150 USB-to-serial converter
- Documentation and software CD
- Quick installation guide (printed)
- Warranty card

Note: The UPort 1130/1130I/1150 also come with 1 mini DB9F-to-TB serial connector.

UPort 1150I Package Checklist

- 1 UPort 1150I USB-to-serial converter
- USB cable: CBL-USBA/B-100
- Velcro lock-down strap for the USB cable
- Documentation and software CD
- Quick installation guide (printed)
- Warranty card

Power Accessory Selection Guide

Barrel Plug Type		Non-locking barrel plug		Locking barrel plug			
O/P		12 VDC, 1.5 A, 100 to 240 VAC		12 VDC, 3 A 100 to 240 VAC (Switch Mode)			
Plug Type		CN	US/JP	EU	AU	UK	CN
Model Name		PWR-12150-CN-S2	PWR-12300-WPUSJP-S1	PWR-12300-WPEU-S1	PWR-12300-WPAU-S1	PWR-12300-WPUK-S1	PWR-12300-WPCN-S1
Appearance							
2 ports	UPort 1250	-	-	-	-	-	-
	UPort 1250I	✓	-	-	-	-	-
	UPort 2210	-	-	-	-	-	-
4 ports	UPort 1410	✓	-	-	-	-	-
	UPort 1450	✓	-	-	-	-	-
	UPort 1450I	✓	-	-	-	-	-
	UPort 2410	-	-	-	-	-	-
	UPort 204	-	✓	✓	✓	✓	✓
7 ports	UPort 404	-	✓	✓	✓	✓	✓
	UPort 207	-	✓	✓	✓	✓	✓
8 ports	UPort 407	-	✓	✓	✓	✓	✓
	UPort 1610-8	✓	-	-	-	-	-
16 ports	UPort 1650-8	✓	-	-	-	-	-
	UPort 1610-16	-	-	-	-	-	-
	UPort 1650-16	-	-	-	-	-	-

Barrel Plug Type		Locking barrel plug						
O/P		12 VDC 2 A, 100 to 240 VAC (desktop type)		2.5A/250 V Power Cord, 183 cm				
Plug Type		Must be used with a power cord		US	JP	EU	AU	UK
Model Name		PWR-12125-DT-S2	PWC-C7US-2B-183	PWC-C7JP-2B-183	PWC-C7EU-2B-183	PWC-C7AU-2B-183	PWC-C7UK-2B-183	
Appearance								
2 ports	UPort 1250	✓	✓	✓	✓	✓	✓	
	UPort 1250I	✓	✓	✓	✓	✓	✓	
	UPort 2210	-	-	-	-	-	-	
4 ports	UPort 1410	✓	✓	✓	✓	✓	✓	
	UPort 1450	✓	✓	✓	✓	✓	✓	
	UPort 1450I	✓	✓	✓	✓	✓	✓	
	UPort 2410	-	-	-	-	-	-	
	UPort 204	-	-	-	-	-	-	
7 ports	UPort 404	-	-	-	-	-	-	
	UPort 207	-	-	-	-	-	-	
8 ports	UPort 407	-	-	-	-	-	-	
	UPort 1610-8	✓	✓	✓	✓	✓	✓	
16 ports	UPort 1650-8	✓	✓	✓	✓	✓	✓	
	UPort 1610-16	✓	✓	✓	✓	✓	✓	
	UPort 1650-16	✓	✓	✓	✓	✓	✓	