

CEE Flanged sockets sloping

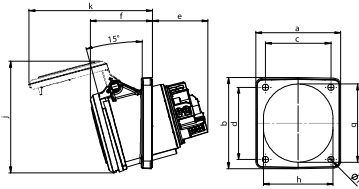

Flanged socket sloping IP44 POWER TWIST

	63 Amp			63 Amp			63 Amp		
Poles	3	4	5	3	4	5	3	4	5
Flange a [mm]	100	100	100	100	100	100	106	106	106
Flange b [mm]	112	112	112	107	107	107	110	110	110
Fixing center c [mm]	80	80	80	77	77	77	90	90	90
Fixing center d [mm]	88	88	88	85	85	85	90	90	90
e [mm]	64	64	64	64	64	64	64	64	64
f [mm]	74	74	74	74	74	74	74	74	74
g [mm]	92	92	92	92	92	92	92	92	92
h [mm]	82	82	82	82	82	82	82	82	82
i [mm]	7	7	7	7	7	7	7	7	7
j [mm]	132	132	132	132	132	132	132	132	132
k [mm]	146	146	146	146	146	146	146	146	146
Wire flexible [mm ²]	6-16								
Wire solid [mm ²]	6-25								
Contact screws [Ncm]	200								
Weight [g]	447	492	547	443	488	543	450	395	550

- contact frame with screws
- housing material: PA6
- contacts: brass with lamellar contact CuBe
 - to order with pilot contact please add a „5“ e.g. 43351-6 (see page 8)
 - to order with pilot contact system (PCS) please add a „6“ e.g. 43361-6 (see page 8)

IP44 splashproof

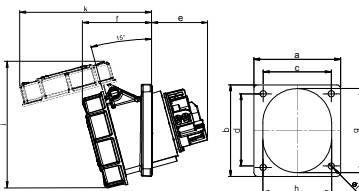

Flanged socket sloping IP67 POWER TWIST

	63 Amp			63 Amp			63 Amp		
Poles	3	4	5	3	4	5	3	4	5
Flange a [mm]	100	100	100	100	100	100	106	106	106
Flange b [mm]	112	112	112	107	107	107	110	110	110
Fixing center c [mm]	80	80	80	77	77	77	90	90	90
Fixing center d [mm]	88	88	88	85	85	85	90	90	90
e [mm]	64	64	64	64	64	64	64	64	64
f [mm]	80	80	80	80	80	80	80	80	80
g [mm]	92	92	92	92	92	92	92	92	92
h [mm]	82	82	82	82	82	82	82	82	82
i [mm]	7	7	7	7	7	7	7	7	7
j [mm]	148	148	148	148	148	148	148	148	148
k [mm]	154	154	154	154	154	154	154	154	154
Wire flexible [mm ²]	6-16								
Wire solid [mm ²]	6-25								
Contact screws [Ncm]	200								
Weight [g]	495	540	595	491	536	591	498	443	598

- contact frame with screws
- housing material: PA6
- contacts: brass with lamellar contact CuBe
 - to order with pilot contact please add a „5“ e.g. 4355-6 (see page 8)
 - to order with pilot contact system (PCS) please add a „6“ e.g. 4356-6 (see page 8)

IP66/67 watertight

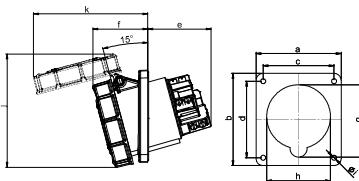

Flanged socket sloping IP67 POWER TWIST

	125 Amp			125 Amp		
Poles	3	4	5	3	4	5
Flange a [mm]	120	120	120	114	114	114
Flange b [mm]	130	130	130	114	114	114
Fixing center c [mm]	100	100	100	90	90	90
Fixing center d [mm]	108	108	108	90	90	90
e [mm]	92	92	92	92	92	92
f [mm]	77	77	77	77	77	77
g [mm]	102	102	102	102	102	102
h [mm]	90	90	90	90	90	90
i [mm]	7	7	7	7	7	7
j [mm]	160	160	160	160	160	160
k [mm]	162	162	162	162	162	162
Wire flexible [mm ²]	16-50					
Wire solid [mm ²]	16-70					
Contact screws [Ncm]	450					
Weight [g]	804	896	995	792	880	987

- contact frame with hexagon socket screws
- housing material: PA6
- contacts: brass with lamellar contact CuBe
 - to order with pilot contact please add a „5“ e.g. 4455-6 (see page 8)
 - to order with pilot contact system (PCS) please add a „6“ e.g. 4456-6 (see page 8)

IP66/67 watertight

