

CEE Flanged sockets straight

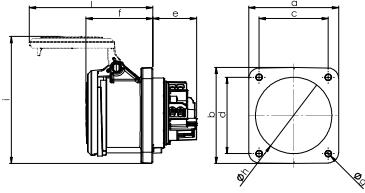

Flanged socket straight IP44 POWER TWIST

	63 Amp			63 Amp		
	3	4	5	3	4	5
Poles	3	4	5	3	4	5
Flange a [mm]	100	100	100	100	100	100
Flange b [mm]	100	100	100	107	107	107
Fixing center c [mm]	80	80	80	77	77	77
Fixing center d [mm]	80	80	80	85	85	85
e [mm]	50	50	50	50	50	50
f [mm]	75	75	75	75	75	75
g [mm]	7	7	7	7	7	7
h [mm]	85	85	85	85	85	85
i [mm]	138	138	138	142	142	142
j [mm]	138	138	138	138	138	138
Wire flexible [mm ²]	6-16					
Wire solid [mm ²]	6-25					
Contact screws [Ncm]	200					
Weight [g]	440	485	539	446	491	545

- contact frame with screws
- housing material: PA6
- contacts: brass with lamellar contact CuBe
 - **to order with pilot contact** please add a „5“, e.g. 33551-6 (see page 8)
 - to order with pilot contact system (PCS) please add a „6“ e.g. 33561-6 (see page 8)

IP44 splashproof

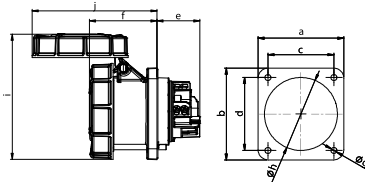

Flanged socket straight IP66/67 POWER TWIST

	63 Amp			63 Amp		
	3	4	5	3	4	5
Poles	3	4	5	3	4	5
Flange a [mm]	100	100	100	100	100	100
Flange b [mm]	100	100	100	107	107	107
Fixing center c [mm]	80	80	80	77	77	77
Fixing center d [mm]	80	80	80	85	85	85
e [mm]	50	50	50	50	50	50
f [mm]	80	80	80	80	80	80
g [mm]	7	7	7	7	7	7
h [mm]	85	85	85	85	85	85
i [mm]	147	147	147	147	147	147
j [mm]	146	146	146	146	146	146
Wire flexible [mm ²]	6-16					
Wire solid [mm ²]	6-25					
Contact screws [Ncm]	200					
Weight [g]	488	533	587	494	539	593

- contact frame with screws
- housing material: PA6
- contacts: brass with lamellar contact CuBe
 - **to order with pilot contact** please add a „5“, e.g. 33551-6 (see page 8)
 - to order with pilot contact system (PCS) please add a „6“ e.g. 33561-6 (see page 8)

IP66/67 watertight

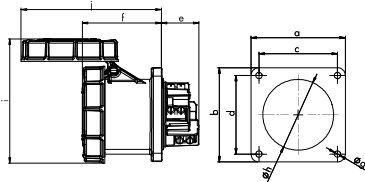

Flanged socket straight IP66/67 POWER TWIST

	125 Amp		
	3	4	5
Poles	3	4	5
Flange a x b [mm]	120	120	120
Fixing center c x d [mm]	100	100	100
e [mm]	48	48	48
f [mm]	101	101	101
g [mm]	8	8	8
h [mm]	90	90	90
i [mm]	159	159	159
j [mm]	179	179	179
Wire flexible [mm ²]	16-50		
Wire solid [mm ²]	16-70		
Contact screws [Ncm]	450		
Weight [g]	752	890	986

- contact frame with hexagon socket screws
- housing material: PA6
- contacts: brass with lamellar contact CuBe
 - **to order with pilot contact** please add a „5“, e.g. 34551-6 (see page 8)
 - to order with pilot contact system (PCS) please add a „6“ e.g. 34561-6 (see page 8)

IP66/67 watertight

